

This document is the property of Amphenol Corporation and is delivered on the express condition that it is not to be disclosed, reproduced or used, in whole or in part, for manufacture or sale by anyone other than Amphenol Corporation without its prior consent, & that no right is granted to disclose or to use any information in this document.

CUSTOMER DRAWING

REVISIONS				
SYM	ECN	DESCRIPTION	DATE	APPROVED
1	CD----	PRELIMINARY PROPOSAL	Sep.24,2013	YH.Hou
2	CD----	CHANGE 1.00MM TO 1.26MM PER CUSTOMER REQUEST	Oct.07,2013	YH.Hou
3	CD0447	CHANGE THE HOUSING PER CUSTOMER REQUEST	Feb.18,2014	YH.Hou

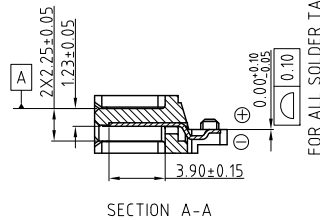
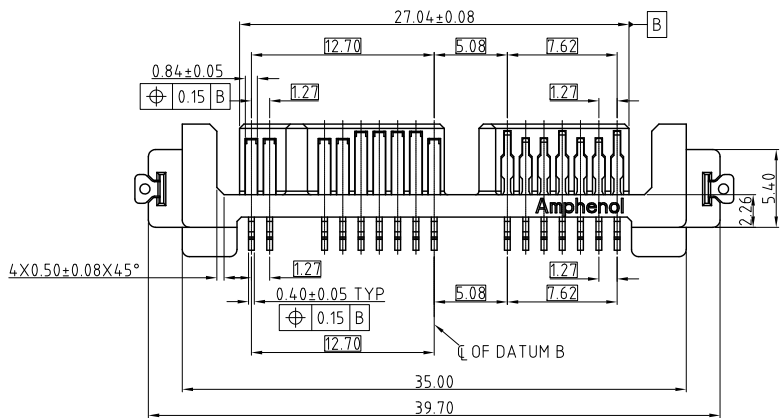
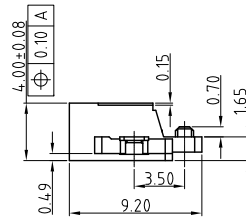
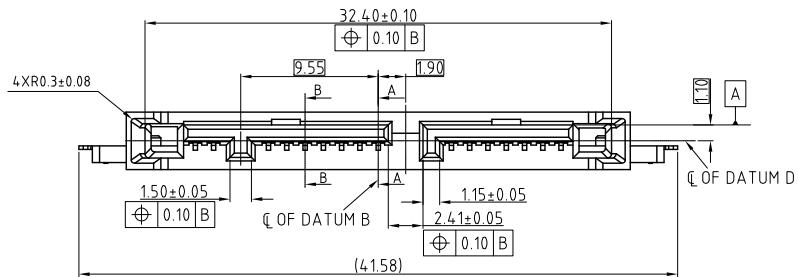
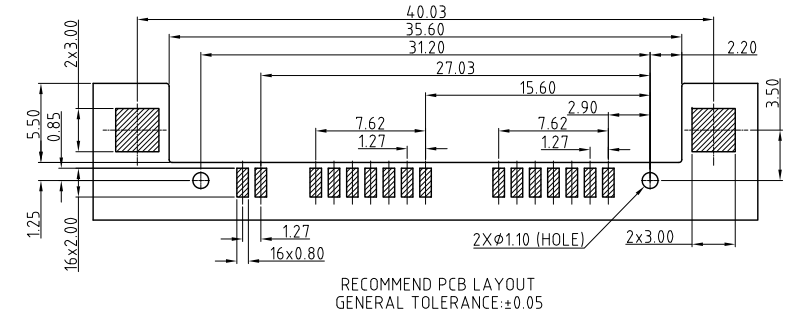
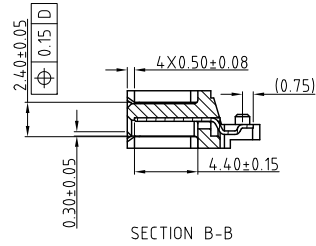
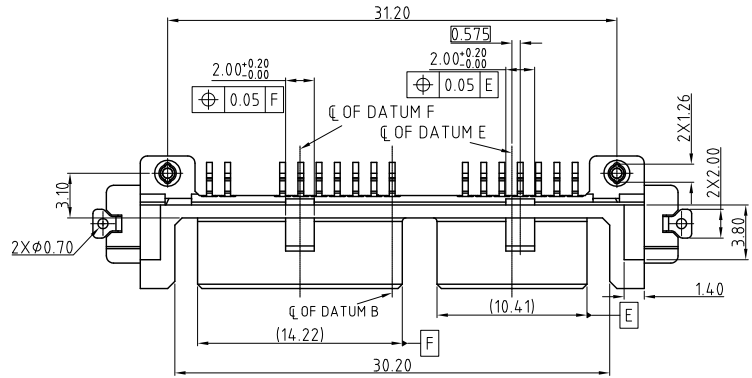

NOTE:

- MATERIAL:
 - HOUSING: HIGH TEMPERATURE LCP BLACK UL94-V0
 - CONTACT: BRASS ALLOY
 - BOARD LOCK: BRASS ALLOY
 - PLATING:
 - CONTACT: MATING AREA: GOLD PLATING THICKNESS REFER TO P/N SYSTEM.
 - SOLDER AREA: 2.54 MICROINCH MIN MATTE TIN OVER 1.27 MICROINCH MIN NICKEL UNDER PLATED
 - BOARD LOCK: 2.54 MICROINCH MIN MATTE TIN OVER 1.27 MICROINCH MIN NICKEL UNDER PLATED
 - ELECTRICAL PERFORMANCE:
 - RATED CURRENT: 1.5A/PIN
 - VOLTAGE STRENGTH: 500V FOR 1 MINUTE
 - LLCR: 30MΩ MAX.
 - INSULATION RESISTANCE: 1000MΩ MIN.
- △ CONTACT MUST BE ABOVE PLASTIC ALONG EFFECTIVE MATING AREA THE LEADING CORNER OF THE CONTACT SHALL CHAMFERED AND HAVE NO SHARP EDGES
- MATERIAL SHOULD BE FULFILLED AMPHENOL SPEC# S-SN-004
 - ORDERING P/N SYSTEM: MSATA0010016XX
 - PACKING METHOD:
 - 1-PACKING WITH TRAY.
 - 2-PACKING WITH TAPE AND REEL.
 - MATING AREA PLATING:
 - 1-Au 0.76 MICROINCH MIN.
 - 2-Au 0.38 MICROINCH MIN.
 - 3-GOLD FLASH

UNLESS OTHERWISE SPECIFIED TOLERANCES		APPROVAL	DATE
	U.S.	DRAWN Teng.Cao	Feb.18,2014
	METRIC	CHECKED LY.YI	Feb.18,2014
X +/-	0.35	APPROVED	
.XX +/-	0.25		
.XXX +/-	0.15		
FRACTIONS +/-		DRAWING FILE :	
ANGLES +/-	5°	DRAWING\SATA\CMSATA0010016XX.dwg	
FOR MATERIALS AND FINISHES SEE NOTES		ANGLE OF PROJECTION	
REMOVE SHARP EDGES			
DIMENSIONS		SIZE DRAWING NO.	
—U.S.—	INCHES	A3	C MSATA-001-0016-X-X
(METRIC)	(mm)	SCALE	SHEET 1 OF 2
		NONE	

Amphenol			
TITLE			
MICRO SATA REVERSE SMT PLUG			
REV.		3	

This document is the property of Amphenol Corporation and is delivered on the express condition that it is not to be disclosed, reproduced or used, in whole or in part, for manufacture or sale by anyone other than Amphenol Corporation without its prior consent, & that no right is granted to disclose or to use any information in this document.

CUSTOMER DRAWING

REVISIONS				
SYM	ECN	DESCRIPTION	DATE	APPROVED
REFER TO SHEET 1				

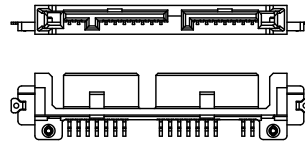
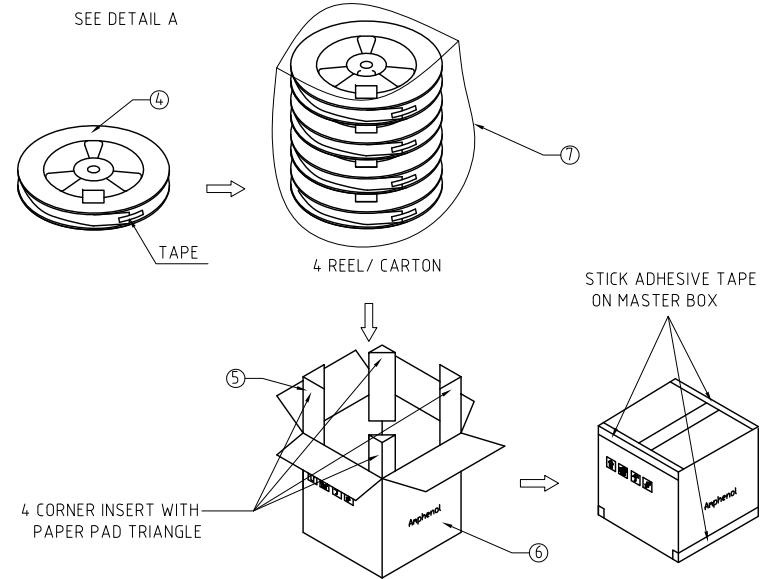
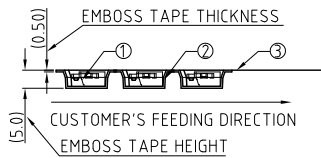
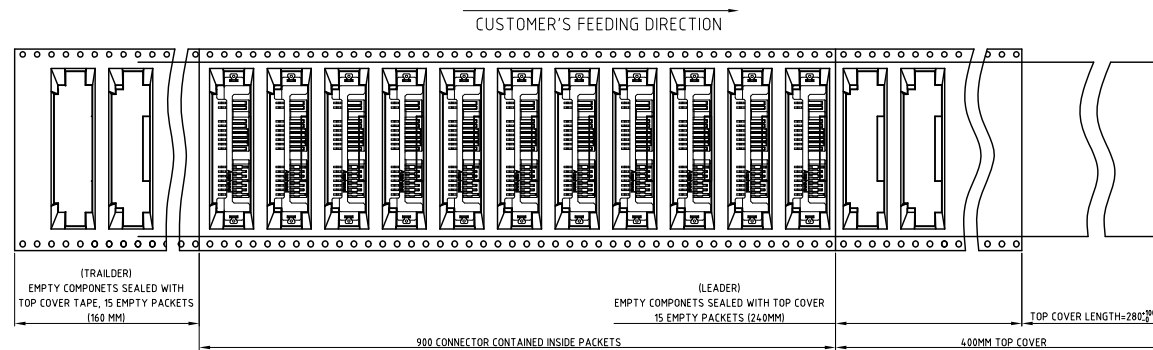
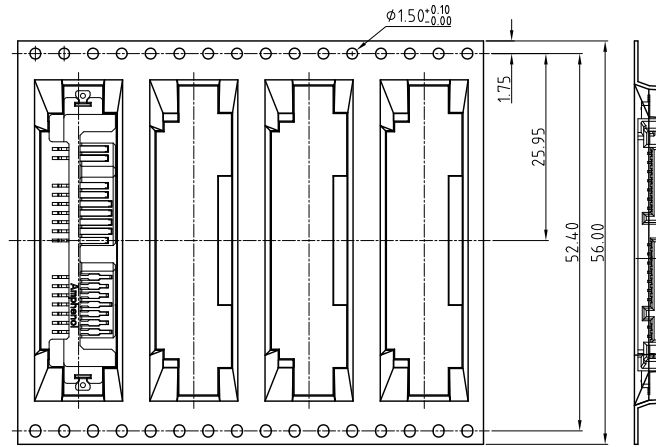
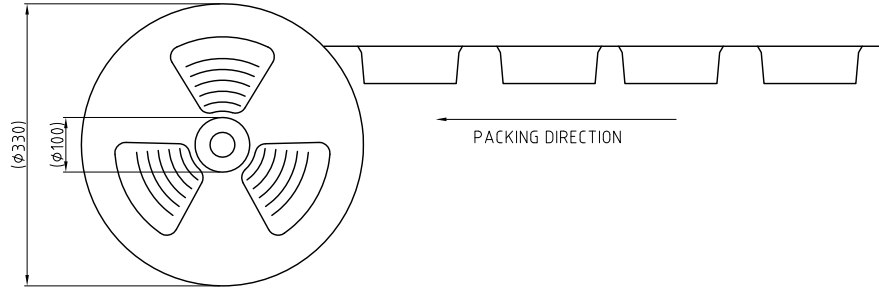

THIS PAGE FOR REFERENCE ONLY

7	PLASTIC BAG	
6	PAPER PAD TRIANGLE	CORRUGATED FIBERBOARD
5	MASTER BOX	CORRUGATED FIBERBOARD
4	PP REEL	PP
3	TOP COVER TAPE	PET
2	EMBOSS TAPE	POLYSTYRENE
1	Connector	
ITEM	DESCRIPTION	MATERIAL

UNLESS OTHERWISE SPECIFIED TOLERANCES		APPROVAL	DATE
	U.S.	DRAWN Teng.Cao	Feb.18,2014
	METRIC	CHECKED LY.YI	Feb.18,2014
X	+/-	APPROVED	
.XX	+/-		
.XXX	+/-		
FRACTIONS	+/-		
ANGLES	+/-		
		DRAWING FILE :	
		DRAWING\SATA\CMSATA0010016XX.dwg	
		REMOVE SHARP EDGES	ANGLE OF PROJECTION
DIMENSIONS			
—U.S.—	INCHES		
(METRIC)	(mm)		

Amphenol			
TITLE MICRO SATA REVERSE SMT PLUG			
SIZE	DRAWING NO.	REV.	
A3	C MSATA-001-0016-X-X	3	
SCALE	NONE	SHEET 2 OF 2	