

This document is the property of Amphenol Corporation and is delivered on the express condition that it is not to be disclosed, reproduced or used, in whole or in part, for manufacture or sale by anyone other than Amphenol Corporation without its prior consent, & that no right is granted to disclose or to use any information in this document.

REVISIONS

SYM	ECN	DESCRIPTION	DATE	APPROVED
1	NA	FIRST RELEASE	6/27/12	IP
2	NA	CORRECT DRAWING AND UPDATE DRAWING	6/29/12	IP
3	NA	CHANGE THE 6xHOLE FROM 0.55mm TO 0.60mm BY CUSTOMER'S REQ	7/03/12	IP
4	NA	ADDED DIMENSIONS BY CUSTOMER'S REQ	7/04/12	IP
5	NA	UPDATE FOOTPRINT BY CUSTOMER'S REQ	7/09/12	IP
6	NA	ADDED STAND-OFF BY CUSTOMER'S REQ; ADDED SHEET 2	7/12/12	IP
7	NA	CHANGE THE FOOTPRINT FROM 1.60mm to 2.0MM	7/27/12	IP
8	NA	CORRECT DRAWING: CHANGED 3.0MM TO 2.8MM	8/01/12	IP
9	NA	UPDATE DRAWING: CHANGED PN SYSTEM ADDED "P" AHEAD	8/13/12	IP
10	HK7012	UPDATE DRAWING FOR MASS PRODUCTION	01/07/14	IP

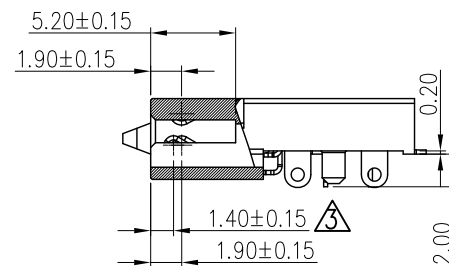
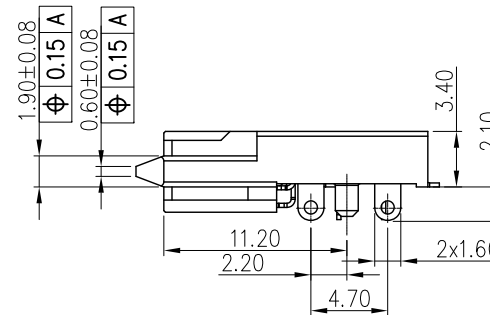
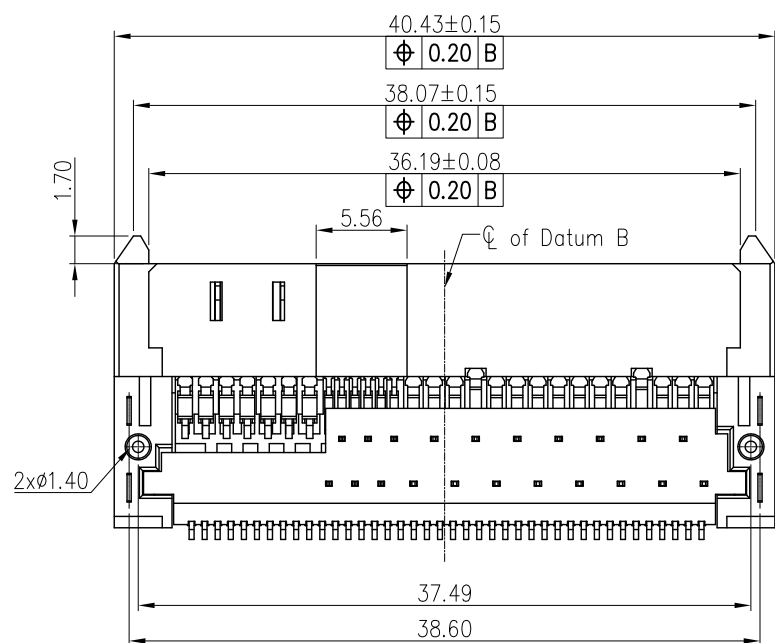
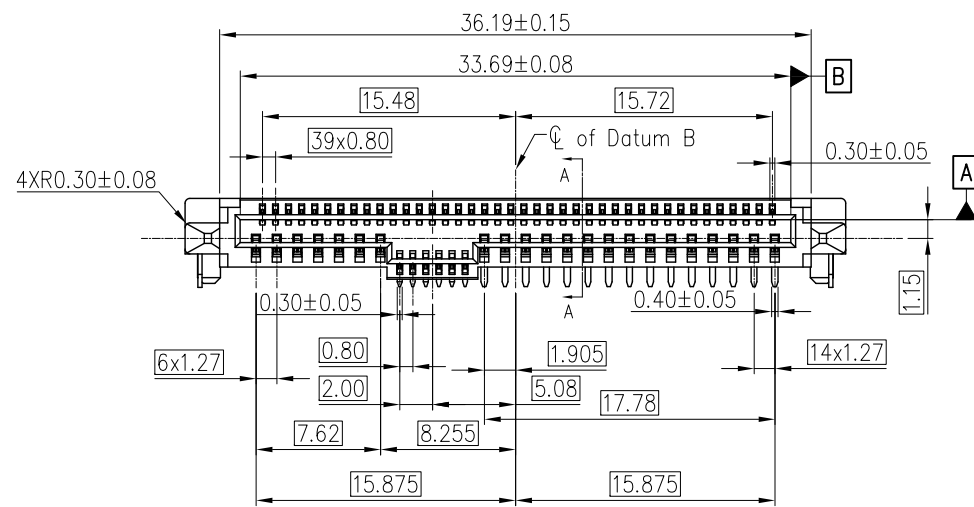
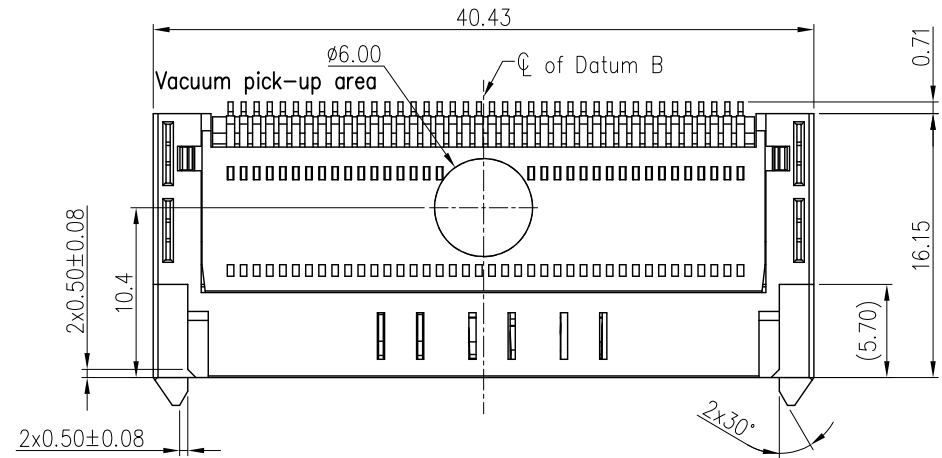

HF

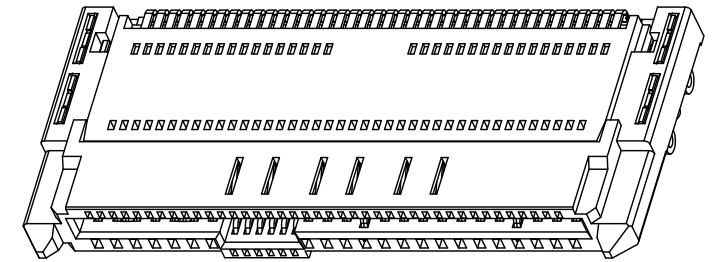

NOTES:

- 1.MATERIAL HOUSING: HIGH TEMPERATURE PLASTIC. UL94V-0, BLACK.
- CONTACT: PHOSPHOR BRONZE
- PLATING: REFER TO P/N SYSTEM ON MATING AREA
 - 1.27~2.54um NICKEL UNDERPLATE OVERALL
 - 2.54~5.08um PURE MATTE TIN ON SOLDER TAIL
- SOLDER CLIP: COPPER ALLOY, 2.54~5.08um PURE TIN PLATED OVERALL
- 1.27~2.54um NICKEL UNDERPLATE
- 2.ELECTRICAL SPECIFICATION:
 - CONTACT RESISTANCE: 30mΩ MAX.
 - INSULATOR RESISTANCE: 1000MΩ MIN.
 - DIELECTRIC WITHSTANDING VOLTAGE: 500 V AC

⚠️ PREMATING AT P4 & P12

4. ORDER P/N SYSTEM: PSAS-F213-021-X-XX

- MATING AREA PLATING
 - 1- 0.76um MIN Au.
 - 2- 0.38um MIN Au.
 - 3- Gold FLASH
- PACKING STYLE
 - NIL- TRAY
 - TR- TAPE AND REEL

UNLESS OTHERWISE SPECIFIED TOLERANCES		APPROVAL		DATE	Amphenol Amphenol East Asia Limited									
	U.S.	METRIC	DRAWN	Fuan.Jiang		01/07/14								
.X	+/-	0.50	CHECKED											
.XX	+/-	0.25	CHECKED											
.XXX	+/-	0.20	CHECKED											
FRACTIONS +/-		3"	DRAWING FILE :											
ANGLES +/-			DRAWING\PSAS\CPSASF213021XXX-10											
REMOVE SHARP EDGES		ANGLE OF PROJECTION												
DIMENSIONS														
U.S.	INCHES													
(METRIC)	(MM)	<table border="1"> <tr> <td>TITLE</td> <td colspan="2">Customer Drawing For</td> </tr> <tr> <td>SIZE</td> <td colspan="2">12G PCIe/SAS R/A Hybrid RECEPTACLE</td> </tr> <tr> <td>SCALE</td> <td>NONE</td> <td>SHEET 1 OF 2</td> </tr> </table>				TITLE	Customer Drawing For		SIZE	12G PCIe/SAS R/A Hybrid RECEPTACLE		SCALE	NONE	SHEET 1 OF 2
TITLE	Customer Drawing For													
SIZE	12G PCIe/SAS R/A Hybrid RECEPTACLE													
SCALE	NONE	SHEET 1 OF 2												

This document is the property of Amphenol Corporation and is delivered on the express condition that it is not to be disclosed, reproduced or used, in whole or in part, for manufacture or sale by anyone other than Amphenol Corporation without its prior consent, & that no right is granted to disclose or to use any information in this document.

REVISIONS				
SYM	ECN	DESCRIPTION	DATE	APPROVED
REFER TO SHEET 1				

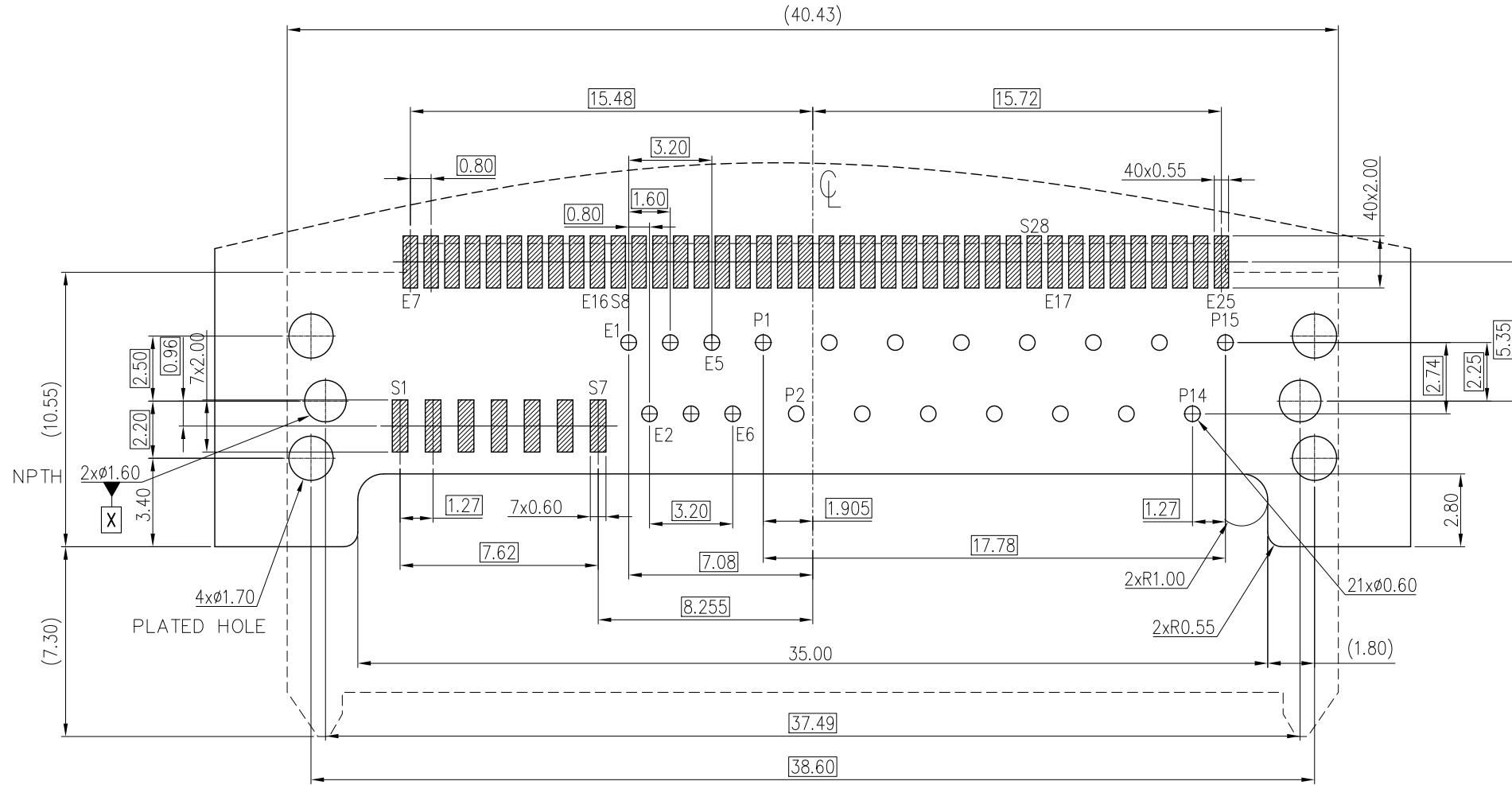

RECOMMENDED PCB LAYOUT
PCB THICKNESS 2.35mm

HF



UNLESS OTHERWISE SPECIFIED TOLERANCES U.S. METRIC .X +/- 0.50 .XX +/- 0.25 .XXX +/- 0.20 FRACTIONS +/- 3" ANGLES +/- FOR MATERIALS AND FINISHES SEE NOTES REMOVE SHARP EDGES DIMENSIONS U.S. INCHES (METRIC) (MM)	APPROVAL DRAWN Fuan.Jiang CHECKED CHECKED	DATE 01/07/14	Amphenol Amphenol East Asia Limited TITLE Customer Drawing For 12G PCIe/SAS R/A Hybrid RECEPTACLE SIZE DRAWING NO. REV. A3 C PSAS-F213-021-XXX 10 SCALE NONE SHEET 2 OF 2
	DRAWING FILE : DRAWING\PSAS\CPSASF213021XXX-10		
	ANGLE OF PROJECTION 		
	(METRIC) (MM)		