

This document is the property of Amphenol Corporation and is delivered on the express condition that it is not to be disclosed, reproduced or used, in whole or in part, for manufacture or sale by anyone other than Amphenol Corporation without its prior consent, & that no right is granted to disclose or to use any information in this document.

| REVISIONS | | | | |
|-----------|--------|----------------------------|---------|----------|
| SYM | ECN | DESCRIPTION | DATE | APPROVED |
| 10 | HK5849 | RELEASE TO MASS PRODUCTION | 8/12/09 | IP |

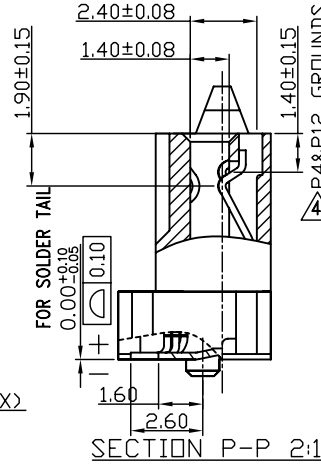
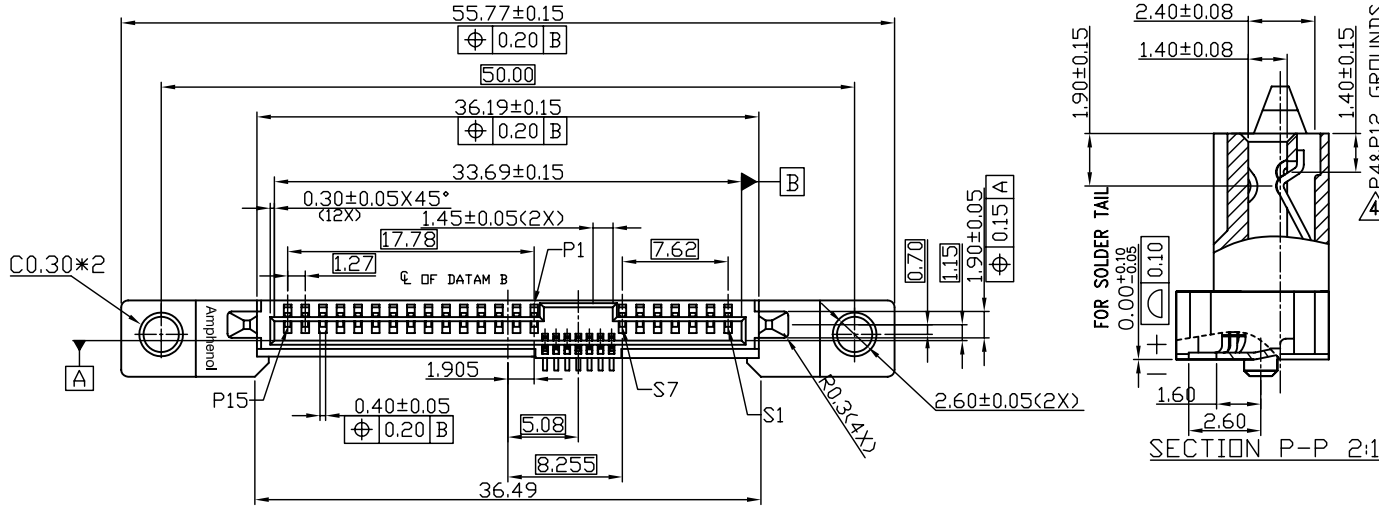

NOTES:

1. Material HOUSING: THERMOPLASTIC, UL94V-0
COLOR: BLACK
CONTACT: PHOSPHOR BRONZE
PLATING: UNDER PLATING WITH NICKEL 1.27u MIN.
OVER PLATING WITH GOLD ON MATING AREA
GOLD PLATING THICKNESS REFER TO P/N SYSTEM
PURE TIN 2.54u MIN. PLATING ON TERMINAL
2. ELECTRICAL SPECIFICATION: MAXIMUM RATED CURRENT: 1.5Amps@30°C MAX.
CONTACT RESISTANCE: 30 MILLI-OHMS MAX.
INSULATOR RESISTANCE: 1000MEGOHMA MIN.
DIELECTRIC WITHSTANDING VOLTAGE: 500 V AC
3. MATERIAL SHOULD BE FULFILLED AMPHENOL SPEC# SSN002.
4. PREMATING AT P4 & P12
5. ORDER P/N SYSTEM: SAS-F310-001-X-XX

MATING AREA PLATING: 1-Au 0.76um MIN. 2-Au 0.38um MIN. 3-Au GOLD FLASH
PACKING: NIL-TRAY WITHOUT PICK-UP CAP C-TRAY WITH PICK-UP CAP TR-TAPE AND REEL WITH PICK-UP CAP

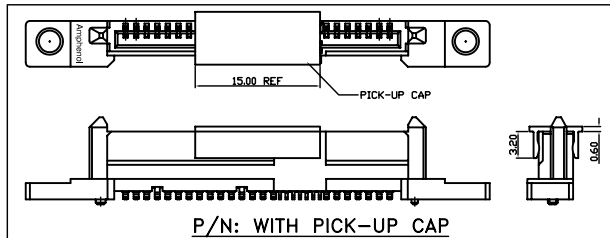
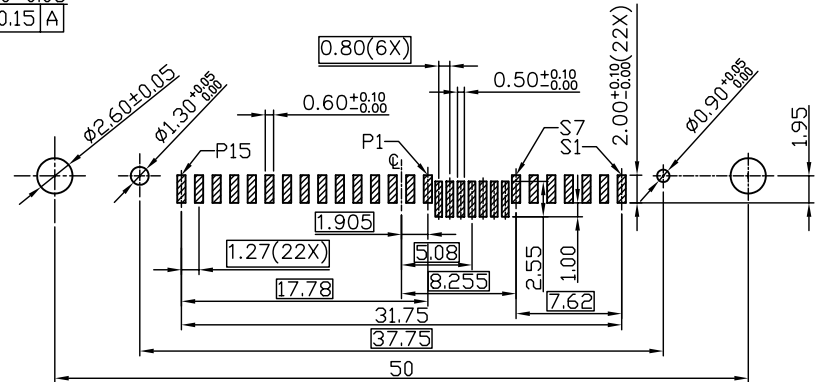
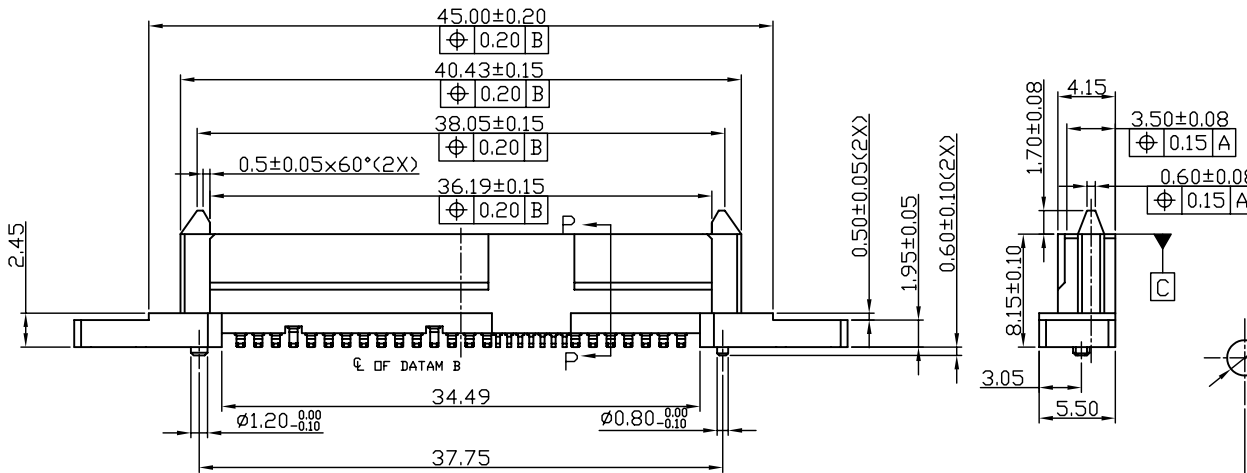

Customer Drawing

| UNLESS OTHERWISE SPECIFIED TOLERANCES | | APPROVAL | | DATE | | Amphenol | | |
|---------------------------------------|------|--------------------|----------|---------------------------------|--|---|--|-------------------------|
| | U.S. | | DRAWN | Wilson.Lu | 6/01/09 | TITLE CUSTOMER DRAWING FOR 6G SAS STRAIGHT SMT RECEPTACLE | | |
| X | +/- | CHECKED | Tom.Tang | 8/12/09 | SIZE DRAWING NO. REV. A3 C SAS-F310-001-X-XX 10 | | | |
| .XX | +/- | CHECKED | | | | | | SCALE NONE SHEET 1 OF 1 |
| FRACTIONS | +/- | DRAWING FILE : | | DRAWING_SAS_CSASF310001XXX-10 | | | | |
| ANGLES | +/- | REMOVE SHARP EDGES | | ANGLE OF PROJECTION | | | | |
| DIMENSIONS | | U.S. | | INCHES | | | | |
| (METRIC) | | (MM) | | | | | | |